



MORNING STAR RANCH

TUBAC, ARIZONA

MASTER PLAN

GROSVENOR HILLS

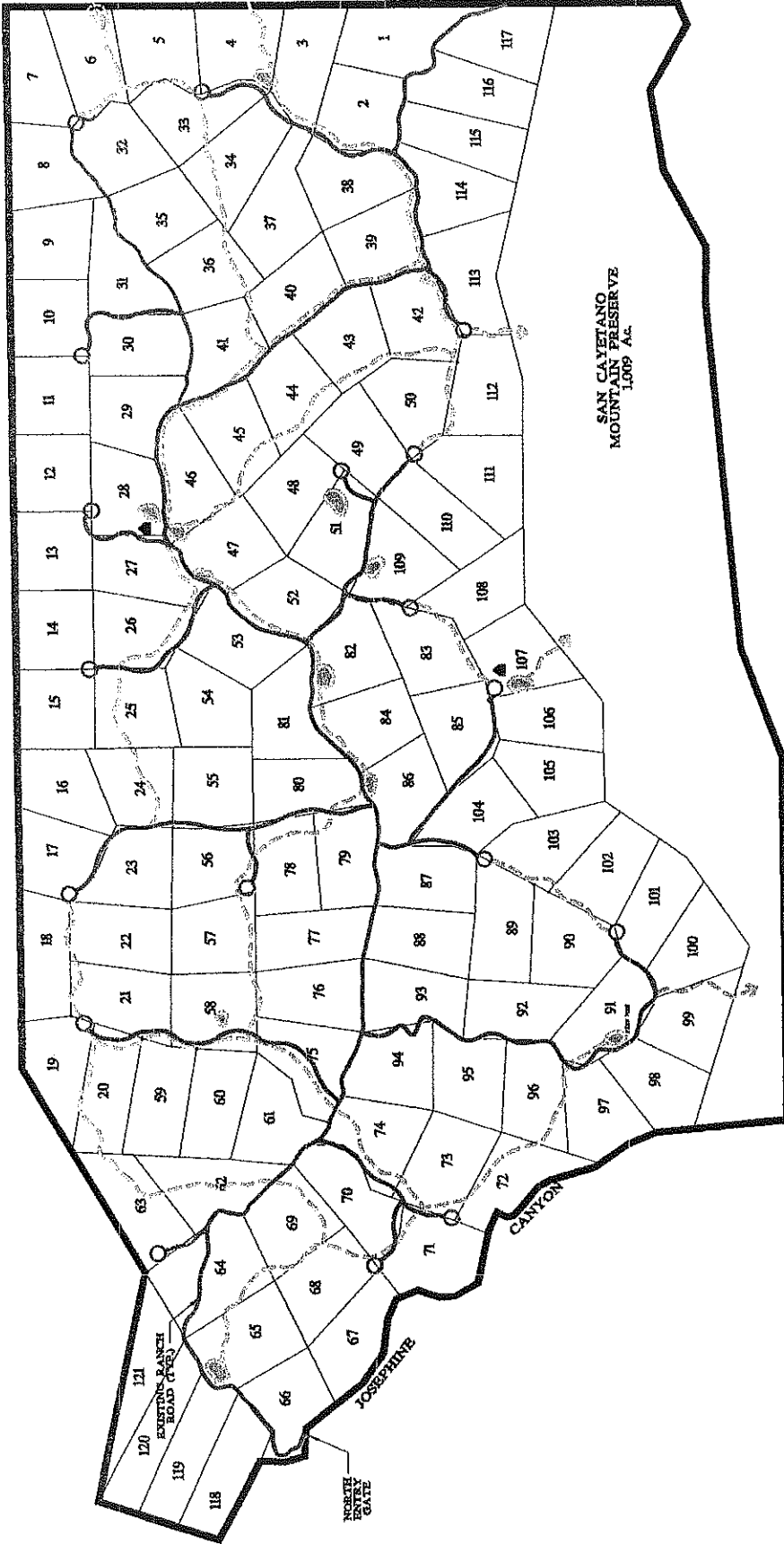

SONOITA CREEK
STATE NATURAL AREA
5,000 AC

SAN CAYETANO
MOUNTAIN PRESERVE
1,009 AC

JOSEPHINE
CANYON

NORTH
ENTRY
GATE

EXISTING RANCH
ROAD (OVER)



GRAPHIC SCALE
0 500 1000 2000
(IN FEET)



LEGEND:

- ROADS
- TRAILS
- WATER FEATURE
- RAMADA